

Web Sign Up!

1. To Sign Up for Amwell, Visit: www.chp.amwell.com
2. Click "Sign Up" at the bottom of the screen. Fill out your name, email, create a password and click the green "sign up" button.



3. Fill out your location, birthday, gender, and click "Continue".



4. Enter your health insurance information to keep your patient account up to date. Then, enter "CHP" (not case sensitive) in the Service Key field and click "Finish".

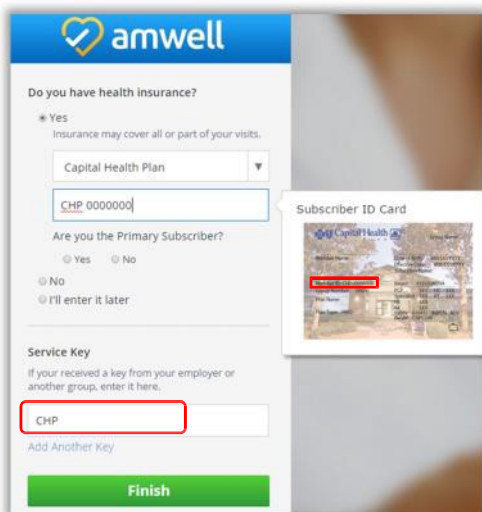

5. When you are ready to have a visit, be sure to update the location to where you are at the time of the visit (go to top of page and click "Location" to update). Choose a provider and enter necessary fields.



6. Enter the information required. Your insurance information will be populated (as long it was entered during the time of enrollment), click "Continue", then enter your payment information.

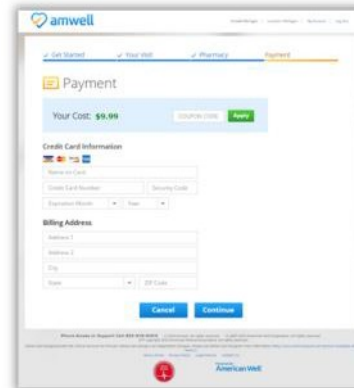

7. You will connect with Enhanced Video and see the provider in high definition.



Mobile Sign Up!

1. Search the App Store or Google Play for “Amwell”. Download the Amwell app.

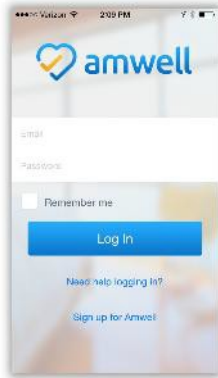

2. Click “Sign Up for Amwell” at the bottom of the screen. Fill out your personal information, your email, create a password, and enter “CHP” for your Service Key under “optional information” as well as your insurance information.

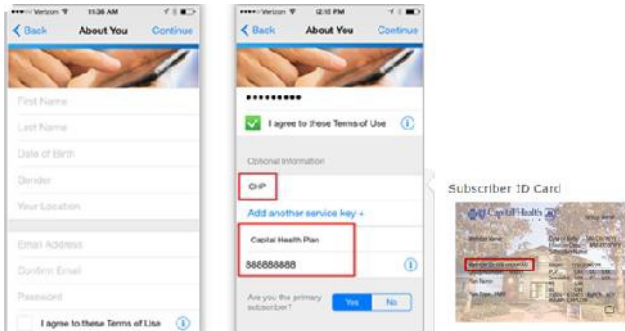

3. When you are ready to have a visit, **be sure to update your location** by going to the “More” option at the bottom of the screen then “My Location” and update your current location.



4. 5. Go back to homepage and choose a provider, then enter the necessary payment information.

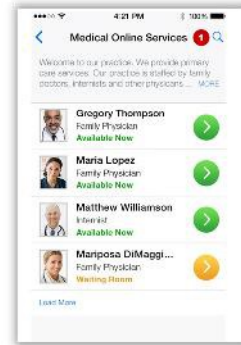

5. Enter your visit information and begin your visit!



For all support questions please call **855-818-DOCS (3627)** or email us at support@americanwell.com